

Connecting to GW1X Wireless Network



Download the GW1X Mobile Configuration File

1. Connect your Mobile Device to gwireless
2. Open up Safari
3. Click on the link to download the Mobile Configuration File



Install the Mobile Configuration File

1. Press Install
2. Press Install Now to accept the changes

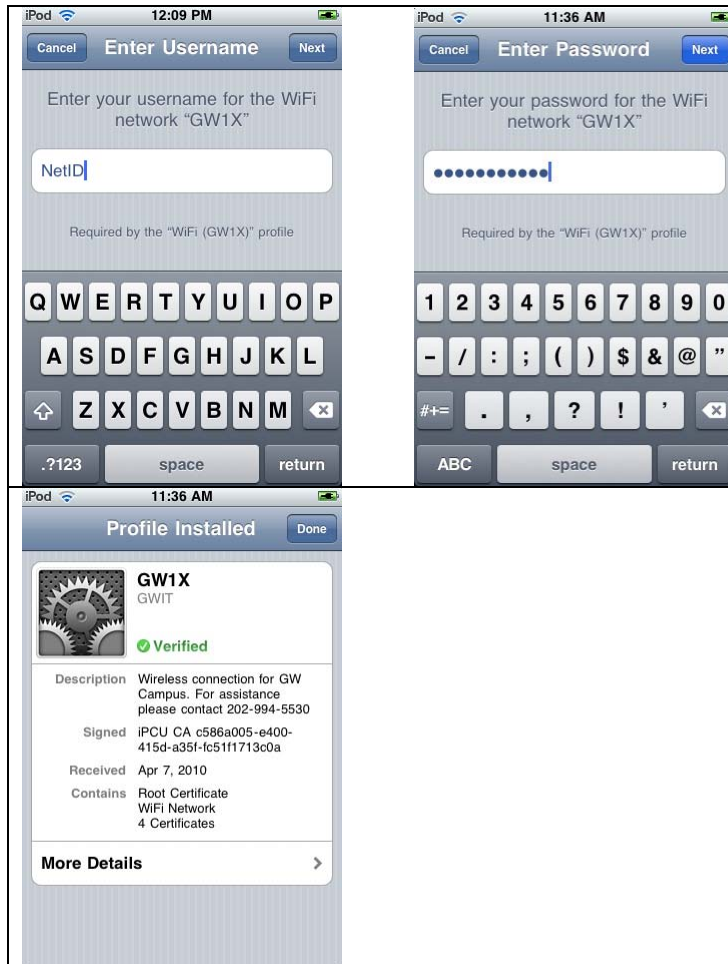

Enter your Net ID and Password

- Your Net ID is the first part of your email address (the part before the @ symbol)
- The password is the same password used to access your GWMail or Colonial Mail account

Press "Done" to finalize installation

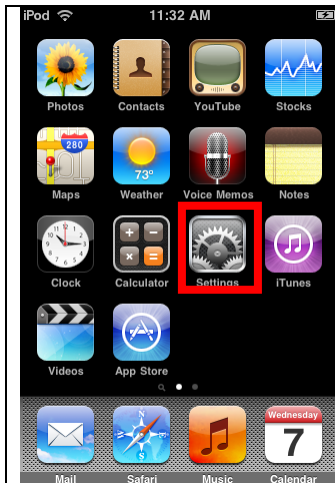
**Connect your device to the GW1X Network**

1. Go back to the home screen
2. Click on "Settings"
3. Click on "Wi-Fi"

**Select the GW1X Network then Accept the Certificate**

1. Select GW1X
2. When the Certificate pops up, select Accept



Wait until the check mark appears next to GW1X.

Congratulations! You are now connected to the GW1X wireless network.



Optional step: Forget the gwireless network.

1. Go back into "Wi-Fi" and press the blue arrow next to gwireless.
2. Press the "Forget this Network button" at the top of the page.

This will prevent your device from connecting to gwireless automatically instead of connecting to the GW1X network. Connecting automatically to gwireless will prevent GW1X from working properly.